





INOX - IVR 667



 Valvola a sfera in tre pezzi in acciaio inox AISI 316
- attacchi flangiati

 Three-piece ball valve in stainless steel AISI 316
- flanged connections

 Kugelhahn dreiteilig aus rostfreiem Stahl AISI 316
- geflanschten Gewinden

 Vanne à boisseau sphérique en acier inox AISI 316
- fixations bridées

 Трёхсоставной кран из нержавеющей стали AISI 316
- фланцевые соединения

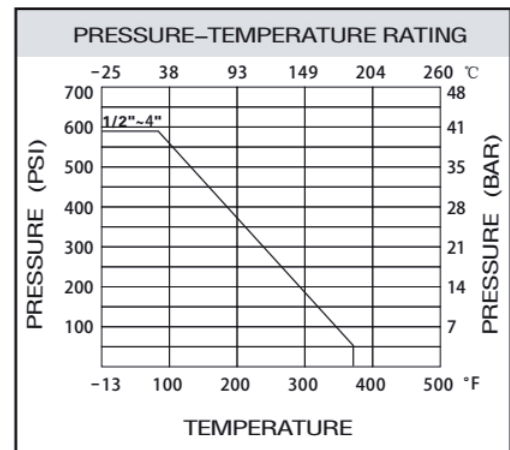
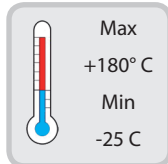
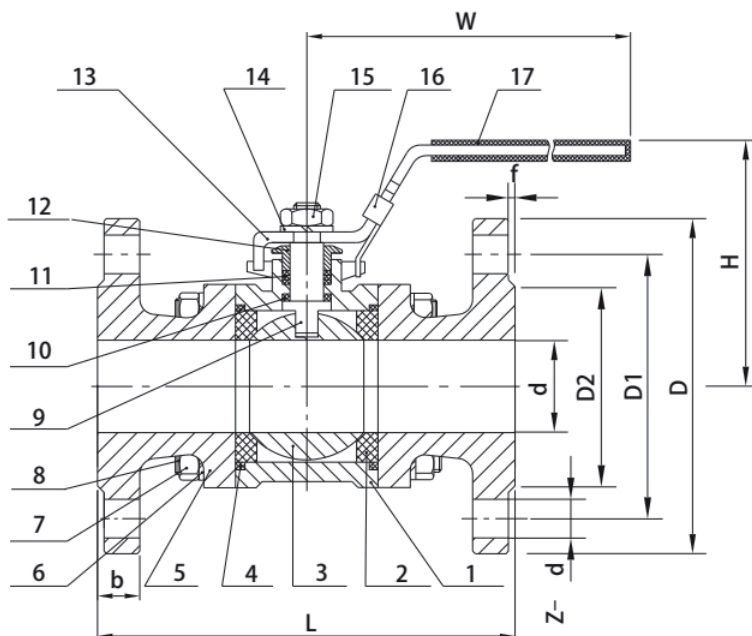

MATERIAL LIST

ITEM	PART	MATERIAL	QTY
1	Body	CF8M	1
2	Ball Seat	R-PTFE (15%)	2
3	Ball	SS316	1
4	Body Gasket	PTFE	2
5	Cap	CF8M	2
6	Spring Washer	SS316	8 (12)
7	Nut	SS304	8 (12)
8	Bolt	SS304	4 (6)
9	Stem	SS316	1
10	Thrust Washer	PTFE	1
11	Stem Packing	PTFE	1
12	Gland Nut	SS304	1
13	Handle	SS304	1
14	Spring Washer	SS304	1
15	Nut	SS304	1
16	Lock Device	SS304	1
17	Handle Cover	Plastic	1

DIMENSION LIST

SIZE	d	D	D1	D2	L	H	W	Z-Ød	b	f	N · m
DN15	15	95	65	45	130	84	148	4-Ø14	16	2	5
DN20	20	105	75	58	150	87	148	4-Ø14	18	2	8
DN25	25	115	85	68	160	93	170	4-Ø14	18	2	10
DN32	32	140	100	78	180	99	170	4-Ø18	18	2	14
DN40	40	150	110	88	200	114	212	4-Ø18	18	3	18
DN50	50	165	125	102	230	122	212	4-Ø18	20	3	25
DN65	65	185	145	122	290	150	254	8-Ø18	22	3	48
DN80	80	200	160	138	310	161	254	8-Ø18	24	3	75
DN100	100	235	190	162	350	180	285	8-Ø22	24	3	110