





# SATURN I COASSIALE TERMOSTATIZZABILE PER RADIATORI



-  Valvola coassiale termostaticabile per radiatori con volantino manuale. Attacchi tubo ferro, con raccordo adattatore per tubo PE-X, multistrato e tubo rame. Bocchettone con autotenuta.  
*Impieghi : Adatte per utilizzo su ogni tipo di radiatore.*
-  Coaxial thermostatic radiators valve with operating plastic cap, iron pipe connection, with adapter fitting for PE-X, multilayer and copper pipe connection - auto-seal tail piece.  
*Application : Suitable for use with any model of radiator.*
-  Thermostatisierbare Ventil Koaxial Heizkörper mit manuelle Handrad. Eisenrohre-Anschluss, mit Anschluss PE-X, Kupferrohr und Mehrschichtrohr. Anschluss-Stutzen mit Selbstdichtigkeit.  
*Anwendungen: Die Ventilen IVR 530 passen sich für den Einsatz auf jedem Heizkörper typ an.*
-  Coaxial robinets de radiateur thermostatisables, raccord F et écrou prisonnier avec raccord adaptateur pour PE-X, tube multi couches, ou tube cuivre. Raccord union avec auto-étanche.  
*Application : Adapt pour une utilisation sur tous les types de radiateurs.*
-  Коаксиальный термостатический радиаторный вентиль с регулирующим пластиковым колпачком, соединение для стальной трубы, с фитингом для труб: металлопластиковой, медной и PE-X, с самогерметизирующимся уплотнением хвостовика.  
*Применение: может устанавливаться на любой тип радиатора.*

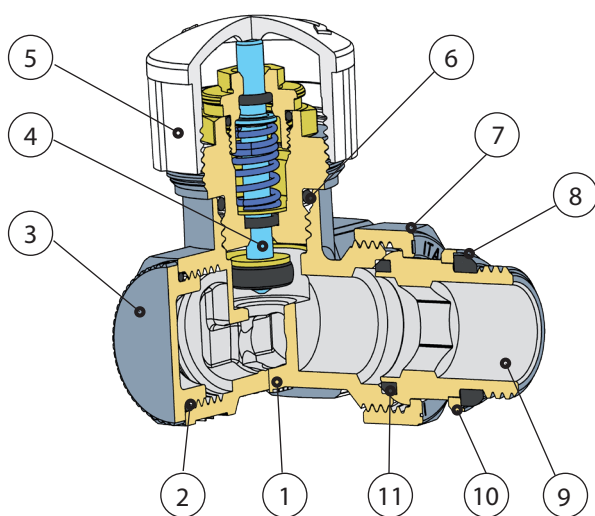

N	DENOMINAZIONE PART NAME	MATERIALE MATERIAL	TRATTAMENTO TREATMENT
1	Corpo - Body	Ottone - Brass CW 617N - UNI EN 12165/98	Nichelato Nickel plated
2	O Ring	EPDM	
3	Tappo - Plug	Ottone - Brass CW 614N - UNI EN 12164/98	Nichelato Nickel plated
4	Vitone - Bonnet		
5	Volantino M30x1.5 Handle M30X1.5	ABS	Ral 9010
6	O Ring	EPDM	
7	Calotta - Nut	Ottone - Brass CW 617N - UNI EN 12165/98	Nichelato Nickel plated
8	Guarnizione - Gasket rubber	EPDM	
9	Bocchettone - Tail piece	Ottone - Brass CW 617N - UNI EN 12165/98	Nichelato Nickel plated
10	Ranella - Washer	Ottone - Brass CW 614N - UNI EN 12164/98	Nichelato Nickel plated
11	Guarnizione - Gasket	PTFE	

## Dati tecnici - Technical data

Pressione massima di esercizio Max. working pressure	10 bar
Pressione differenziale massima Max. Differential pressure	1 bar
Max. glicole Max. glycol	50 %
Corsa di chiusura Working length	2.9 mm.

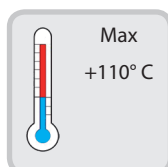

Raccordo per adattatore per tubo PEX - multistrato e rame  
Adapter fitting for PEX - multilayer and copper pipe

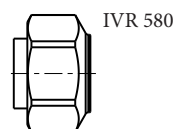
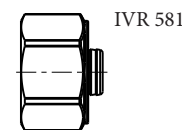
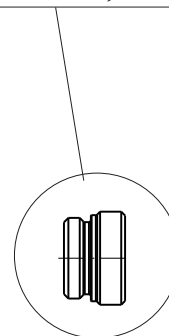
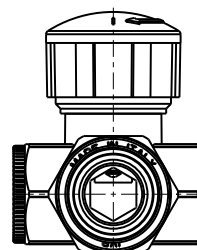

Tutte le caratteristiche tecniche dei prodotti sono soggette a modifiche senza preavviso - All product's technical specifications are subject to modification without prior notice

IVR S.p.A. - Via Brughiera III, 1 - Loc. Piano Rosa - 28010 Boca (NO) Italy - Phone: +39.0322.888811 - Fax: +39.0322.888892-93 - Email: vendite@ivrvalvole.it - Website: www.ivrvalvole.it

## DIAGRAMMA PERDITE DI CARICO FLOW AND PRESSURE DROP

IVR 530 3/8" Kvs 0.9 QmN 176

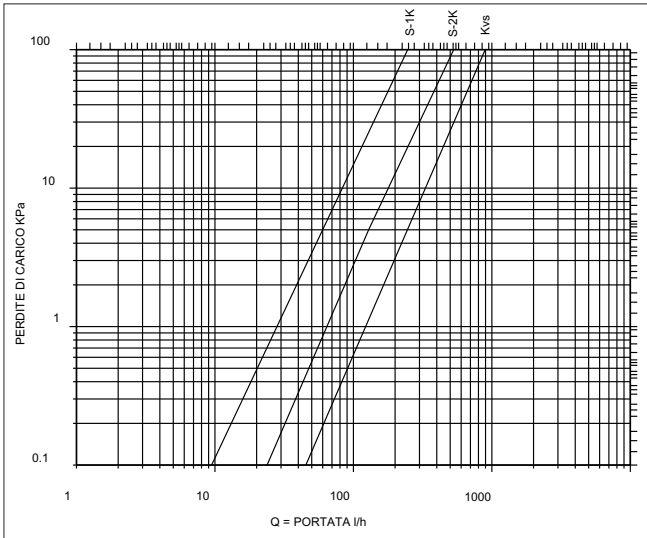

IVR 530 1/2" Kvs 1 QmN 181

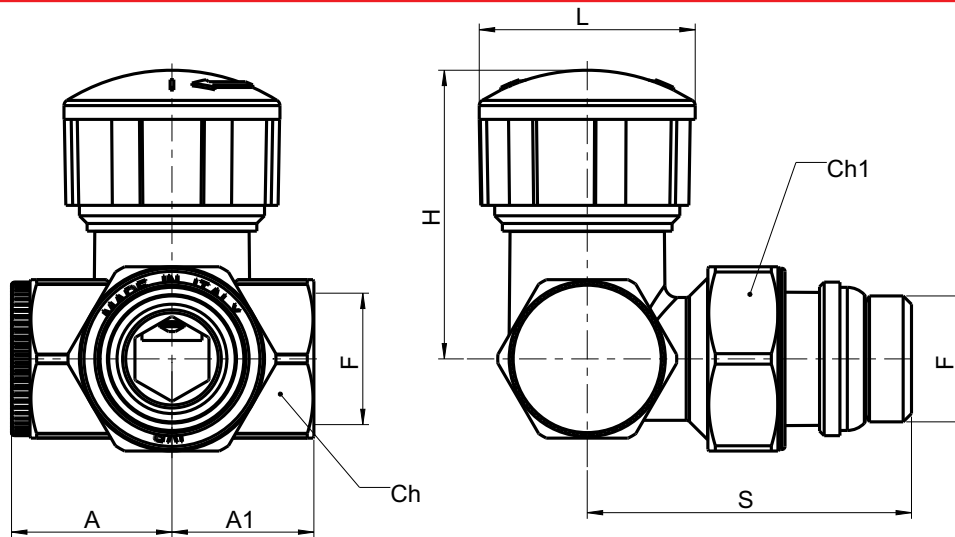
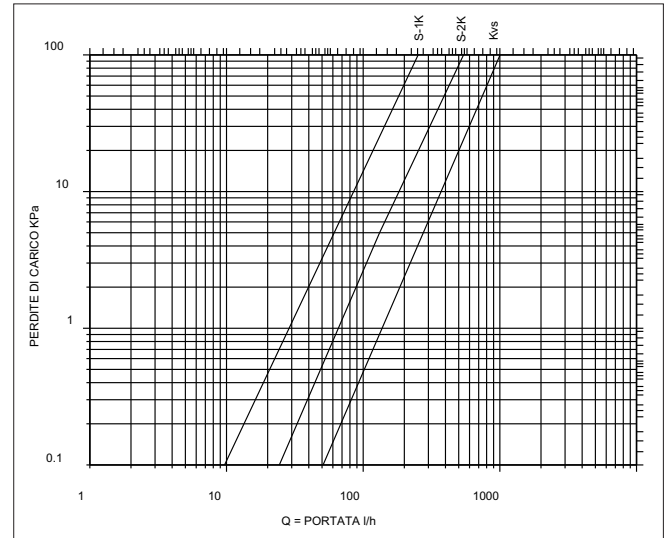

### DIMENSIONI - DIMENSIONS (mm)

Size	F	A1	A	S	H	L	Ch	Ch1
3/8"	3/8"	20	23	48	47	31	22	25
1/2"	1/2"	23	26	55	37	31	26	30

### IVR 530

Codice Code	Mis. Size
153003000	3/8"
153005000	1/2"



### IVR 530 AD

Codice Code	Mis. Size
153003024	3/8" x 18
153005024	1/2" x 18



Le valvole sono abbinabili ai detentori attacchi tubo ferro IVR 553 e IVR 557 per tubo PEX - multistrato e rame  
The valves can be matched to the lockshields with iron pipe connections IVR 553 and for PEX - multilayer and copper pipe IVR 557